

# AUDIOSTORM

## Combo Box V3.0

The Combo Box is an easy-to-use add-on for your combo amplifier that adds a speaker out socket. When nothing is plugged into the Combo Box your speaker signal goes straight-through to your speaker as normal.

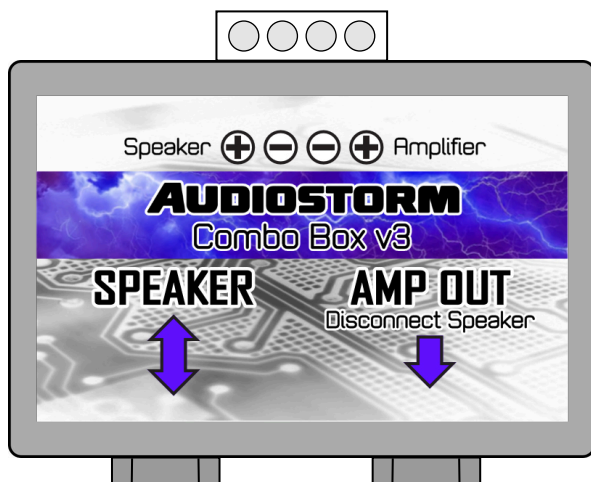

AUDIOSTORM . UK

# Fitting : Push-fit speaker connectors

If your amplifier uses a wire that connects to your speaker with push-fit connectors then you can use this method.

## Negative:

A black or white stripe on the wire. A black dot or - on the speaker.

## Positive:

A red stripe on the wire. A red dot or + on the speaker.

1. Carefully disconnect the female speaker connectors from your speaker and attach them to the male blades on the Combo Box.

If these connectors are difficult to remove check for a small 'locking' tab that you may have to prise with a screwdriver.

2. Attach the combo box long wire with the female connectors to the male blades of your speaker.
3. Find a good spot for the Combo Box and secure with the included adhesive Velcro or screws.

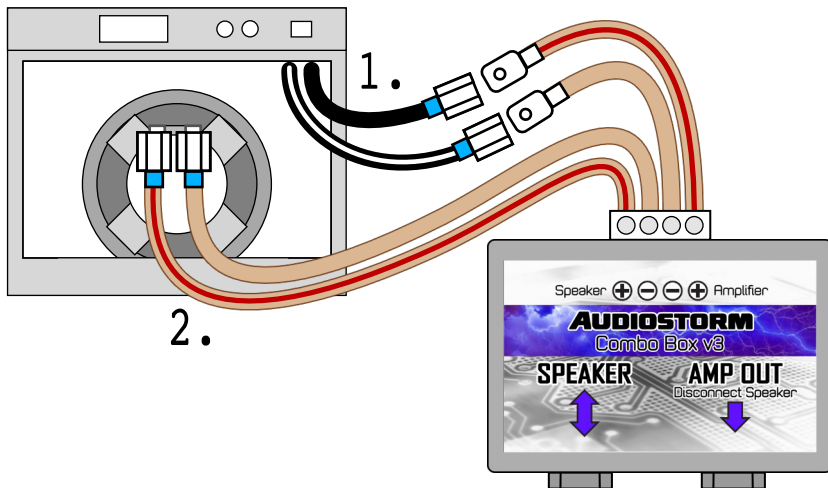

## **Fitting : Soldered wires on Speaker**

First decide upon location for your Combo Box and ensure that the enclosed wires will reach. You may wish to measure and plan this.

1. Cut the existing speaker wire at a point where there will be enough wire to go from amp to Combo Box.
2. Remove the short wire from the Combo Box and attach the newly cut wire from amp to the Combo Box 'Amplifier' (+) and (-).
3. If the remaining wire from the speaker will reach the Combo Box then remove the long wire from the Combo Box and attach.

## **Problem Solving**

3A. If the wire in step 3 is too short to reach the Combo Box then instead of detaching the long wire from the Combo Box simply cut off the terminals at a convenient point and use the included connector block to join up the wires.

3B. If you do not wish to use connector block, or prefer a tidier finish cut the speaker cable away from the speaker as close as possible then use a small file or a soldering iron to carefully remove the remaining copper and solder from the speaker tabs.

Copper and solder are soft metals and can be easily filed away. After filing away the supplied push fit connectors can be used.

Mounting: For a permanent and more secure installation use the included screws instead of the adhesive Velcro.

## **Connector sizes and wire quality**

Most guitar speakers use 5.2 mm spade connectors. Automotive spades are either 4.8 mm or 6.3 mm and neither will fit a speaker. If you need replacement 5.2 mm connectors we will be happy to supply them.

Most amplifiers use thin speaker cable to connect your speakers which can impact tone slightly. Some of our customers report an increase in sound quality when removing these wires and fitting our OFC cables.

## How to use with an Attenuator

As an insert loop for a HotBox attenuator. By connecting a device to both the jack sockets of the Combo Box the attached device is placed in-line, in series between amp and speaker.

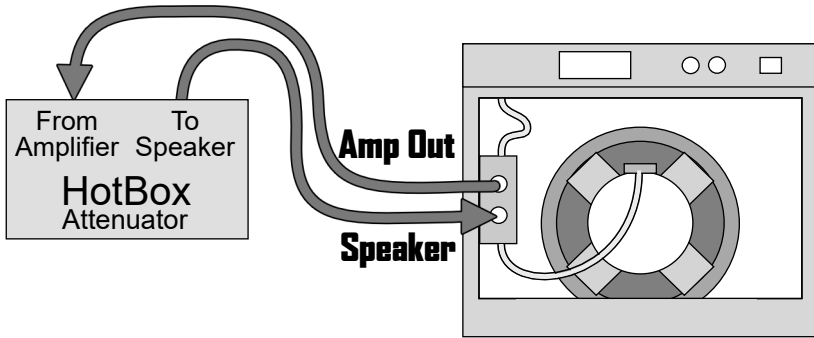

## How to use a Combo Amp as a Cab

1. Turn the combo OFF
2. Plug a spare cable or dummy jack into the 'Amp In' socket. This disconnects the internal connection to Combo Amp.
3. Connect you external head of amp to the 'Speaker' socket. This connects the external amp to the cab speaker

**ALWAYS ENSURE YOUR COMBO AMP IS TURNED OFF BECAUSE IT HAS NO LOAD WHEN USED LIKE THIS!**

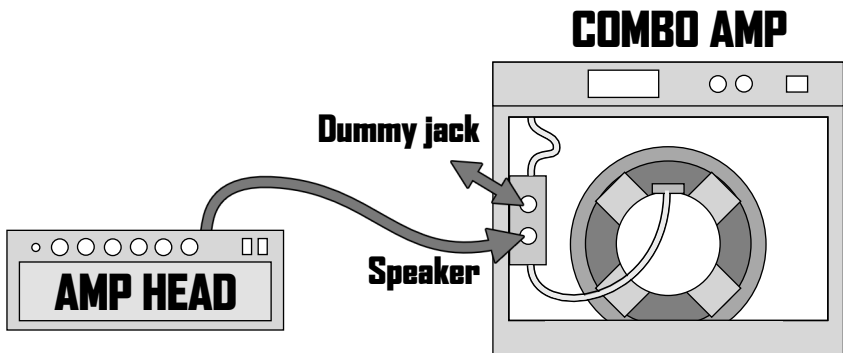

# How to use with an Extension Cab

Use the 'Amp Out' socket to connect to an extension cab. This **DISCONNECTS** the internal speaker and uses **ONLY** the extension cab. (CB v3.0 only).

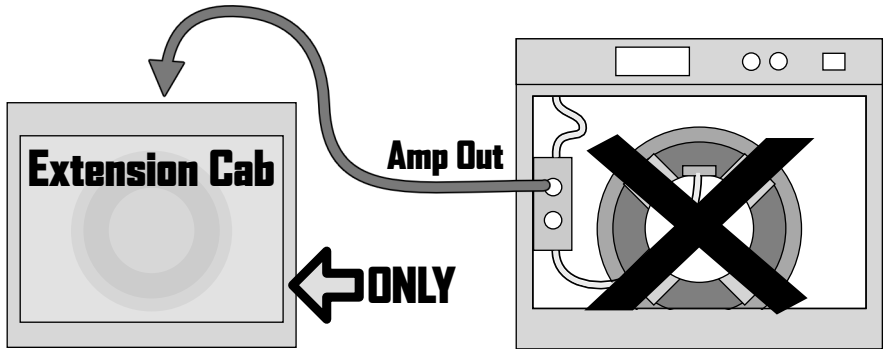

Use the 'Speaker' socket to connect to an extension cab. This uses **BOTH** speakers in Parallel (CB v3.0 only).

If both speakers are 16 ohm the new total load will be 8 ohms.

If both speakers are 8 ohms the new total load will be 4 ohms.

If both speakers are 4 ohms the new total load will be 2 ohms.

Mixed Speaker loads are not recommended but if you must use differing ohms calculate the parallel value and use the nearest ohms option.

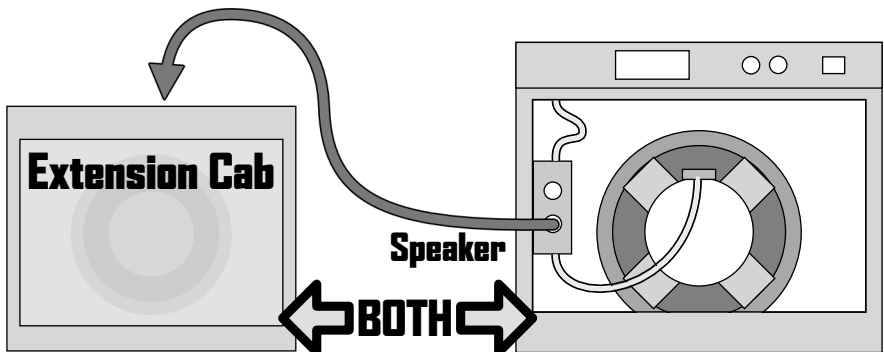

# The Vox AC30 CC2X

This amplifier is a special case and mysteriously has four speaker wires coming from the chassis, two to each speaker.

In actual fact, the yellow and white wires are just connected together inside the amp. They're just a link wire so you can ignore these and leave them connected to your speakers, so they stay in series.

The Red and Black are the actual + and - outputs and so you want to disconnect these and insert the ComBoBox there, treating the two speakers as if they are a single speaker.

**Red | Yellow | White | Black**

